

CILINDRO DOPPIO EFFETTO TIPO "X13"
DOUBLE ACTING CYLINDER "X13" TYPE

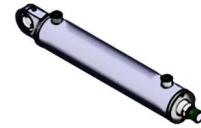

Serie
X13

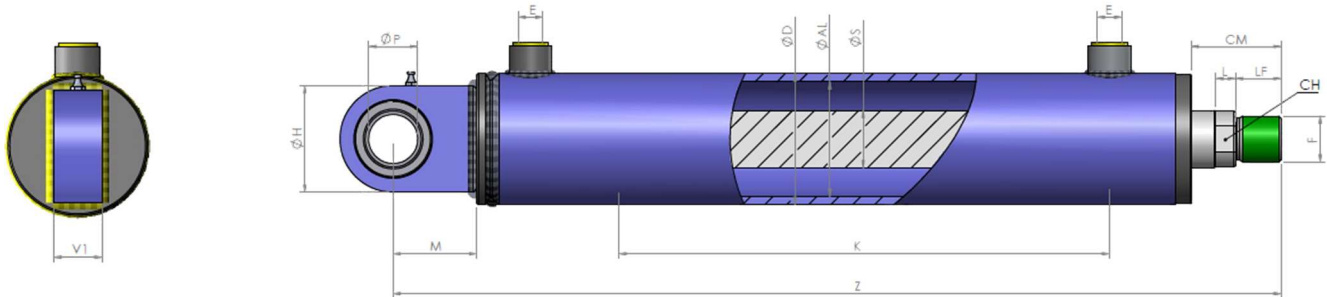

Codice Code	K	Z	Kg	E BSP	CM	F	LF	CH	L	M	P	H	V1	Codice Code	K	Z	Kg
ØD 42 ØAL 32 ØS 20														ØD 50 ØAL 40 ØS 25			
X13-322050	50	220	1,57	1/4"	46	16X1,5	25	17	5	35	16	48	17	X13-4025100	100	298	2,81
X13-3220100	100	270	1,92											X13-4025150	150	348	3,28
X13-3220150	150	320	2,27											X13-4025200	200	398	3,76
X13-3220200	200	370	2,63											X13-4025250	250	448	4,22
X13-3220250	250	420	2,98											X13-4025300	300	498	4,69
X13-3220300	300	470	3,33											X13-4025350	350	548	5,16
X13-3220400	400	570	4,03											X13-4025400	400	598	5,63
X13-3220500	500	670	4,72											X13-4025450	450	846	6,10
ØD 50 ØAL 40 ØS 20														ØD 60 ØAL 50 ØS 30			
X13-4020100	100	298	2,65	1/4"	52	16X1,5	25	17 22	5	38	20	50	19	X13-5025100	100	315	3,83
X13-4020150	150	348	3,05											X13-5025150	150	365	4,36
X13-4020200	200	398	3,45											X13-5025200	200	415	4,89
X13-4020250	250	448	3,85											X13-5025250	250	465	5,42
X13-4020300	300	498	4,19											X13-5025300	300	515	5,95
X13-4020350	350	548	4,65											X13-5025350	350	565	6,48
X13-4020400	400	598	5,05											X13-5025400	400	615	7,01
X13-4020450	450	846	5,44											X13-5025450	450	665	7,54
X13-4020500	500	698	5,85	X13-5025500	500	715	8,07										
ØD 60 ØAL 50 ØS 25														ØD 60 ØAL 50 ØS 30			
X13-5025100	100	315	3,83	3/8"	52	16X1,5	25	22 27	5	45	25	55	23	X13-5030100	100	315	4,12
X13-5025150	150	365	4,36											X13-5030150	150	365	4,70
X13-5025200	200	415	4,89											X13-5030200	200	415	5,40
X13-5025250	250	465	5,42											X13-5030250	250	465	6,00
X13-5025300	300	515	5,95											X13-5030300	300	515	6,60
X13-5025350	350	565	6,48											X13-5030350	350	565	7,20
X13-5025400	400	615	7,01											X13-5030400	400	615	7,81
X13-5025450	450	665	7,54											X13-5030450	450	665	8,42
X13-5025500	500	715	8,07											X13-5030500	500	715	9,00
X13-5025550	550	765	8,60											X13-5030550	550	765	9,70
X13-5025600	600	815	9,66											X13-5030600	600	815	10,90
X13-5025700	700	915	10,72											X13-5030700	700	915	12,10
X13-5025800	800	1015	12,83											X13-5030800	800	1015	14,60
X13-50251000	1000	1215	13,36											X13-50301000	1000	1215	15,30

CILINDRO DOPPIO EFFETTO TIPO "X13"
DOUBLE ACTING CYLINDER "X13" TYPE



Serie
X13

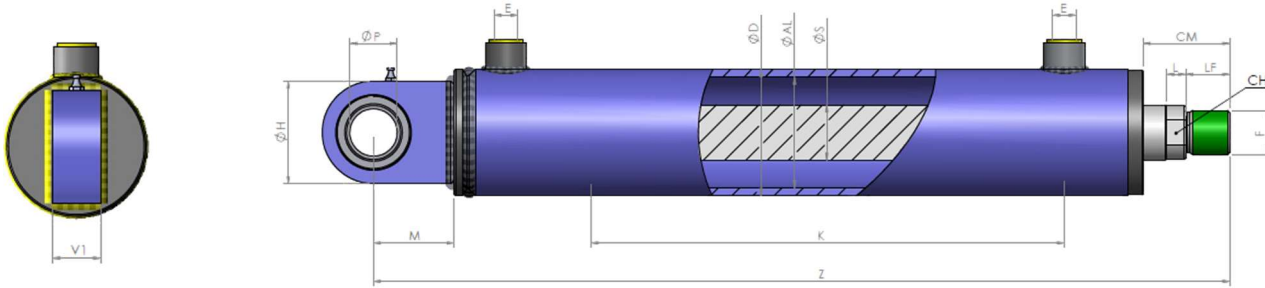

Codice Code	K	Z	Kg	E BSP	C M	F	LF	CH	L	M	P	H	V1	Codice Code	K	Z	Kg										
ØD 70 ØAL 60 ØS 30														ØD 70 ØAL 60 ØS 35													
X13-6030100	100	351	5,75	3/8"	63	22X1,5	32	27 32	8	51	30	65	28	X13-6035100	100	351	5,93										
X13-6030150	150	401	6,43											X13-6035150	150	401	6,73										
X13-6030200	200	451	7,03											X13-6035200	200	451	7,56										
X13-6030250	250	501	7,73											X13-6035250	250	501	8,83										
X13-6030300	300	551	8,43											X13-6035300	300	551	9,03										
X13-6030350	350	601	9,13											X13-6035350	350	601	9,83										
X13-6030400	400	651	9,73											X13-6035400	400	651	10,63										
X13-6030450	450	701	10,43											X13-6035450	450	701	11,43										
X13-6030500	500	751	11,13											X13-6035500	500	751	12,13										
X13-6030550	550	801	11,83											X13-6035550	550	801	12,96										
X13-6030600	600	851	12,43											X13-6035600	600	851	13,73										
X13-6030700	700	951	13,83											X13-6035700	700	951	15,27										
X13-6030800	800	1051	15,13											X13-6035800	800	1051	16,83										
X13-60301000	1000	1251	17,83											X13-60351000	1000	1251	19,93										
ØD 70 ØAL 60 ØS 40														ØD 73 ØAL 63 ØS 40													
X13-6040200	200	451	8,15	3/8"	63	22X1,5	32	36	8	51	30	65	28	X13-6340200	200	451	8,35										
X13-6040250	250	501	9,05											X13-6340250	250	501	9,25										
X13-6040300	300	551	9,95											X13-6340300	300	551	10,15										
X13-6040350	350	601	10,85											X13-6340350	350	601	11,15										
X13-6040400	400	651	11,75											X13-6340400	400	651	12,05										
X13-6040450	450	701	12,65											X13-6340450	450	701	12,90										
X13-6040500	500	751	13,55											X13-6340500	500	751	13,85										
X13-6040550	550	801	14,45											X13-6340550	550	801	14,75										
X13-6040600	600	851	15,25											X13-6340600	600	851	15,65										
X13-6040700	700	951	17,08											X13-6340700	700	951	17,49										
X13-6040800	800	1051	18,85											X13-6340800	800	1051	19,25										
X13-60401000	1000	1251	22,45											X13-63401000	1000	1251	22,95										
ØD 80 ØAL 70 ØS 35																								ØD 80 ØAL 70 ØS 40			
X13-7035100	100	351	6,95											3/8"	63	22X1,5	32	32 36	8	51	30	65	28	X13-7040100	100	351	7,33
X13-7035150	150	401	7,75	X13-7040150	150	401	8,28																				
X13-7035200	200	451	8,65	X13-7040200	200	451	9,25																				
X13-7035250	250	501	9,45	X13-7040250	250	501	10,15																				
X13-7035300	300	551	10,25	X13-7040300	300	551	11,00																				
X13-7035350	350	601	11,05	X13-7040350	350	601	12,05																				
X13-7035400	400	651	11,95	X13-7040400	400	651	13,05																				
X13-7035450	450	701	12,85	X13-7040450	450	701	13,95																				
X13-7035500	500	751	13,65	X13-7040500	500	751	14,95																				
X13-7035550	550	801	14,45	X13-7040550	550	801	15,95																				
X13-7035600	600	851	15,35	X13-7040600	600	851	16,84																				
X13-7035700	700	951	17,00	X13-7040700	700	951	18,76																				
X13-7035800	800	1051	18,65	X13-7040800	800	1051	20,65																				
X13-70351000	1000	1251	22,85	X13-70401000	1000	1251	24,45																				

CILINDRO DOPPIO EFFETTO TIPO "X13"
DOUBLE ACTING CYLINDER "X13" TYPE



Serie
X13

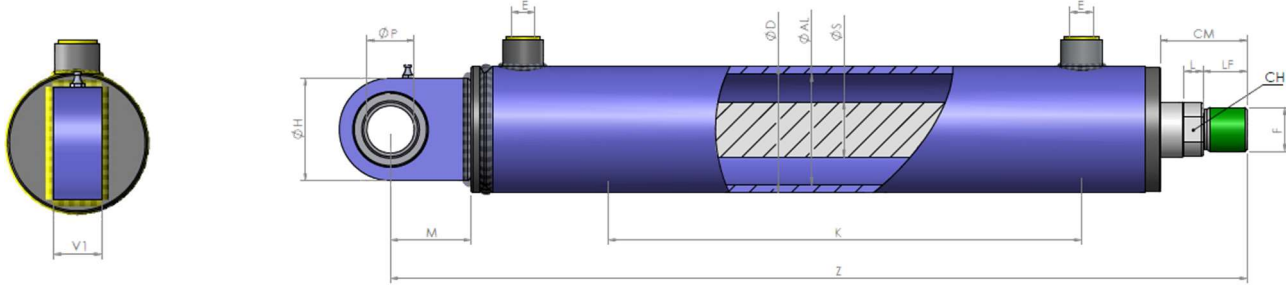

Codice Code	K	Z	Kg	E BSP	CM	F	LF	CH	L	M	P	H	V1	Codice Code	K	Z	Kg
ØD 92 ØAL 80 ØS 40														ØD 92 ØAL 80 ØS 50			
X13-8040200	200	509	13,64	1/2"	85	35X1,5	50	36 46	10	69	40	100	35	X13-8050200	200	509	14,98
X13-80402500	250	559	15,06											X13-8050250	250	559	16,30
X13-8040300	300	609	15,88											X13-8050300	300	609	17,70
X13-8040400	400	709	18,14											X13-8050400	400	709	20,51
X13-8040500	500	809	20,19											X13-8050500	500	809	23,32
X13-8040600	600	909	22,64											X13-8050600	600	909	26,12
X13-8040700	700	1009	24,89											X13-8050700	700	1009	28,92
X13-8040800	800	1109	27,14											X13-8050800	800	1109	31,92
X13-80401000	1000	1309	31,64											X13-80501000	1000	1309	37,42
ØD 105 ØAL 90 ØS 50																	
X13-9050300	300	615	21,72	1/2"	83	35X1,5	50	46	10	69	40	100	35				
X13-9050400	400	715	25,16														
X13-9050500	500	815	28,39														
X13-9050600	600	915	31,72														
X13-9050700	700	1015	35,05														
X13-9050800	800	1115	38,39														
X13-90501000	1000	1315	45,06														
ØD 115 ØAL 100 ØS 50														ØD 115 ØAL 100 ØS 60			
X13-10050200	200	470	22,05	1/2"	85	35X1,5	50	46 55	10	69	40	100	35	X13-10060300	300	570	27,74
X13-10050250	250	520	24,80											X13-10060400	400	670	31,94
X13-10050300	300	570	25,60											X13-10060500	500	770	36,13
X13-10050400	400	670	29,07											X13-10060600	600	870	40,32
X13-10050500	500	770	32,59											X13-10060700	700	970	44,52
X13-10050600	600	870	36,11											X13-10060800	800	1070	48,72
X13-10050700	700	970	39,63											X13-100601000	1000	1270	57,11
X13-10050800	800	1070	43,14														
X13-100501000	1000	1270	49,92														

CARATTERISTICHE TECNICHE

TECHNICAL SPECIFICATIONS



Serie
X13

ALESAGGIO - BORE [mm]		25	32	40	50	60	63	70	80	90	100	120
FORZA IN SPINTA - OUTPUT FORCE [Kg]	p bar 100	501	820	1.281	2.002	2.883	3.179	3.924	5.126	6.487	8.009	11.533
	p bar 160	801	1.312	2.050	3.203	4.613	5.086	6.279	8.201	10.379	12.814	18.452
	p bar 250	1.251	2.050	3.203	5.005	7.208	7.947	9.811	12.814	16.218	20.022	28.831

ALESAGGIO - BORE [mm]		25	32	40		50		60		63	70		80	90	100		120	
STELO - ROD [mm]		16	20	20	25	30	30	35	40	40	35	40	40	50	50	60	70	
FORZA IN TIRO - INPUT FORCE [Kg]	p bar 100	296	500	961	781	1.502	1.281	2.162	1.902	1.602	1.897	2.943	2.643	3.844	4.485	6.007	5.126	7.608
	p bar 160	473	800	1.538	1.249	2.403	2.050	3.460	3.043	2.563	3.036	4.709	4.229	6.151	7.176	9.610	8.201	12.173
	p bar 250	739	1.249	2.403	1.952	3.754	3.203	5.406	4.755	4.004	4.743	7.358	6.607	9.610	11.212	15.016	12.814	19.021

Pressione Massima - Max, Pressure: 250 Bar

Il dato della pressione è sempre da verificare in base all'applicazione del cilindro,

The pressure value is always to be checked depending on the application of the cylinders,

PRODOTTO - PRODUCT	MATERIALE - MATERIAL
TUBO LUCIDO POLISHED TUBE - HONED	ACCIAIO: St 52.3 DIN 2393 ISO H9 - S355 H8 STEEL: St 52.3 DIN 2393 ISO H9 - S355 H8
STELO CROMATO CHROMED ROD	ACCIAIO: UNI C45 - cromo 25µm Rating 9/200h - 20MnV6 STEEL: UNI C45 - chrome 25µm Rating 9/200h - 20MnV6
TESTATA DI GUIDA HEAD BUSH	GHISA: EN-GJL 250 (G25-UNI 5007 / EN 1561) HYDRAULIC CAST IRON: EN-GJL 250 (G25-UNI5007 / EN1561)
PISTONE PISTON	ACCIAIO: 9SMn28 STEEL: 9SMn28
FONDELLO END PLUG	ACCIAIO: S355J0 (Fe510C) - S355JR (A105) STEEL: S355J0 (Fe510C) - S355JR (A105)
BORCHIA FILETTATA THREADED PORT	ACCIAIO STEEL
TERMINALE A SNODO RILUBRIFICABILE BALL-JOINT END WITH GREASE NIPPLE	ACCIAIO: ISO 12240-4 SERIE E - TIPO S STEEL: ISO 12240-4 SERIES E - TYPE S
SET GUARNIZIONI HEAD BUSH - HEAD BUSH SEAL KITS	
GUARNIZIONE: O-RING SEAL: O-RING	NBR 70 SHORE NBR 70 SHORE
GUARNIZIONE: GHK SEAL : GHK	POLIURETANO POLYURETHANE
GUARNIZIONE: TSE-TTS-TTI/L SEAL: TSE-TTS-TTI/L	TSE: NBR+TESSUTO TTS-TTI/L: POLIURETANO TSE: NBR+FABRIC TTS-TTI/L: POLYURETHANE
GUARNIZIONE: O-RNG SEAL: O-RING	NBR 70 SHORE NBR 70 SHORE
SET GUARNIZIONI PISTON - PISTON SEAL KITS	
GUARNIZIONE: TPM - PDP - PDH SEAL: TPM - PDP - PDH	NBR+POM+TPE - NBR+POM+POLIURETANO - NBR+PTFE+POM NBR+POM+TPE - NBR+POM+ POLYURETHANE - NBR+PTFE+POM
GUARNIZIONE: O-RNG SEAL: O-RING	NBR 70 SHORE NBR 70 SHORE
Velocità Limite - Top Speed: max 0,5 m/s - Temperatura C° - Temperature C°: -25°C - +80°C	