

CILINDRO DOPPIO EFFETTO TIPO "X03"
DOUBLE ACTING CYLINDER "X03" TYPE

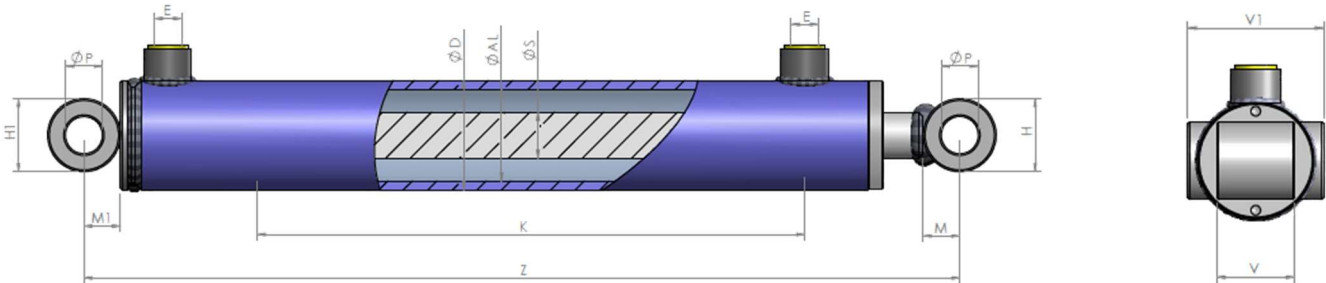

Serie
X03



Codice Code	K	Z	Kg	E BSP	ØP	H	V	M	H1	V1	M1	Codice Code	K	Z	Kg
ØD 42 ØAL 32 ØS 20															
X03-322050	50	190	1,82	1/4"	16,25	35	30	17,5	35	60	17,5				
X03-3220100	100	240	2,16												
X03-3220150	150	290	2,52												
X03-3220200	200	340	2,86												
X03-3220250	250	390	3,22												
X03-3220300	300	440	3,56												
X03-3220400	400	540	4,26												
X03-3220500	500	640	4,98												
ØD 50 ØAL 40 ØS 20															
X03-4020100	100	265	2,82	1/4"	16,25	35	30	17,5	35	60	17,5	ØD 50 ØAL 40 ØS 25			
X03-4020150	150	315	3,23									X03-4025100	100	265	3,01
X03-4020200	200	365	3,63									X03-4025150	150	315	3,46
X03-4020250	250	415	4,03									X03-4025200	200	365	3,95
X03-4020300	300	465	4,43									X03-4025250	250	415	4,39
X03-4020350	350	515	4,83									X03-4025300	300	465	4,89
X03-4020400	400	565	5,23									X03-4025350	350	515	5,35
X03-4020450	450	615	5,63									X03-4025400	400	565	5,80
X03-4020500	500	665	6,03									X03-4025450	450	615	6,28
												X03-4025500	500	665	6,74
				X03-4025550	550	715	7,21								
				X03-4025600	600	765	7,68								
ØD 60 ØAL 50 ØS 25															
X03-5025100	100	280	4,11	3/8"	20,25	40	40	20	40	70	20	ØD 60 ØAL 50 ØS 30			
X03-5025150	150	330	4,67									X03-5030100	100	280	4,35
X03-5025200	200	380	5,19									X03-5030150	150	330	4,95
X03-5025250	250	430	5,73									X03-5030200	200	380	5,64
X03-5025300	300	480	6,25									X03-5030250	250	430	6,18
X03-5025350	350	530	6,78									X03-5030300	300	480	6,80
X03-5025400	400	580	7,31									X03-5030350	350	530	7,41
X03-5025450	450	630	7,83									X03-5030400	400	580	8,02
X03-5025500	500	680	8,36									X03-5030450	450	630	8,64
X03-5025550	550	730	8,90									X03-5030500	500	680	9,25
X03-5025600	600	780	9,41									X03-5030550	550	730	9,88
X03-5025700	700	880	10,50									X03-5030600	600	780	10,48
X03-5025800	800	980	11,54									X03-5030700	700	880	11,69
X03-50251000	1000	1180	13,66									X03-5030800	800	980	12,94
												X03-50301000	1000	1180	15,39

CILINDRO DOPPIO EFFETTO TIPO "X03"
DOUBLE ACTING CYLINDER "X03" TYPE



Serie
X03

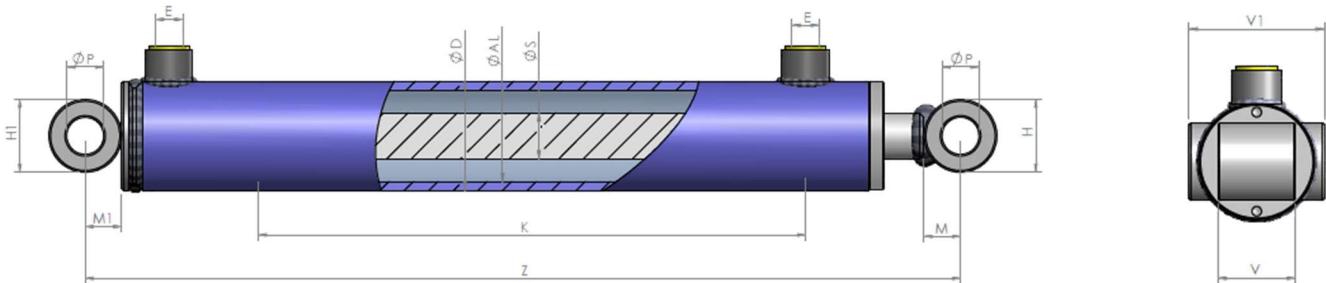

Codice Code	K	Z	Kg	E BSP	ØP	H	V	M	H1	V1	M1	Codice Code	K	Z	Kg
ØD 70 ØAL 60 ØS 30													ØD 70 ØAL 60 ØS 35		
X03-6030100	100	310	6,37	3/8"	25,25	50	50	25	50	80	25	X03-6035100	100	310	6,65
X03-6030150	150	360	7,06									X03-6035150	150	360	7,43
X03-6030200	200	410	7,74									X03-6035200	200	410	8,20
X03-6030250	250	460	8,42									X03-6035250	250	460	8,98
X03-6030300	300	510	9,09									X03-6035300	300	510	9,75
X03-6030350	350	560	9,77									X03-6035350	350	560	10,53
X03-6030400	400	610	10,44									X03-6035400	400	610	11,31
X03-6030450	450	660	11,12									X03-6035450	450	660	12,08
X03-6030500	500	710	11,78									X03-6035500	500	710	12,82
X03-6030550	550	760	12,47									X03-6035550	550	760	13,63
X03-6030600	600	810	13,15									X03-6035600	600	810	14,41
X03-6030700	700	910	14,50									X03-6035700	700	910	15,94
X03-6030800	800	1010	15,84									X03-6035800	800	1010	17,51
X03-60301000	1000	1210	18,55	X03-60351000	1000	1210	20,61								
ØD 70 ØAL 60 ØS 40													ØD 73 ØAL 63 ØS 40		
X03-6040200	200	410	8,82	3/8"	25,25	50	50	25	50	80	25	X03-6340200	200	410	9,08
X03-6040250	250	460	9,71									X03-6340250	250	460	9,98
X03-6040300	300	510	10,60									X03-6340300	300	510	10,89
X03-6040350	350	560	11,49									X03-6340350	350	560	11,81
X03-6040400	400	610	12,40									X03-6340400	400	610	12,72
X03-6040450	450	660	13,29									X03-6340450	450	660	13,63
X03-6040500	500	710	14,17									X03-6340500	500	710	14,54
X03-6040550	550	760	15,05									X03-6340550	550	760	15,45
X03-6040600	600	810	15,95									X03-6340600	600	810	16,35
X03-6040700	700	910	17,79									X03-6340700	700	910	18,18
X03-6040800	800	1010	19,53									X03-6340800	800	1010	20,00
X03-60401000	1000	1210	23,10									X03-63401000	1000	1210	23,65
ØD 80 ØAL 70 ØS 35													ØD 80 ØAL 70 ØS 40		
X03-7035100	100	310	7,70	3/8"	25,25	50	50	25	50	90	25	X03-7040100	100	310	8,15
X03-7035150	150	360	8,61									X03-7040150	150	360	9,11
X03-7035200	200	410	9,45									X03-7040200	200	410	10,01
X03-7035250	250	460	10,25									X03-7040250	250	460	11,02
X03-7035300	300	510	11,09									X03-7040300	300	510	11,97
X03-7035350	350	560	11,96									X03-7040350	350	560	12,87
X03-7035400	400	610	12,80									X03-7040400	400	610	13,83
X03-7035450	450	660	13,63									X03-7040450	450	660	14,80
X03-7035500	500	710	14,41									X03-7040500	500	710	15,73
X03-7035550	550	760	15,31									X03-7040550	550	760	16,76
X03-7035600	600	810	16,07									X03-7040600	600	810	17,63
X03-7035700	700	910	17,82									X03-7040700	700	910	19,59
X03-7035800	800	1010	19,49									X03-7040800	800	1010	21,47
X03-70351000	1000	1210	22,84	X03-70401000	1000	1210	25,28								

CILINDRO DOPPIO EFFETTO TIPO "X03"
DOUBLE ACTING CYLINDER "X03" TYPE



Serie
X03

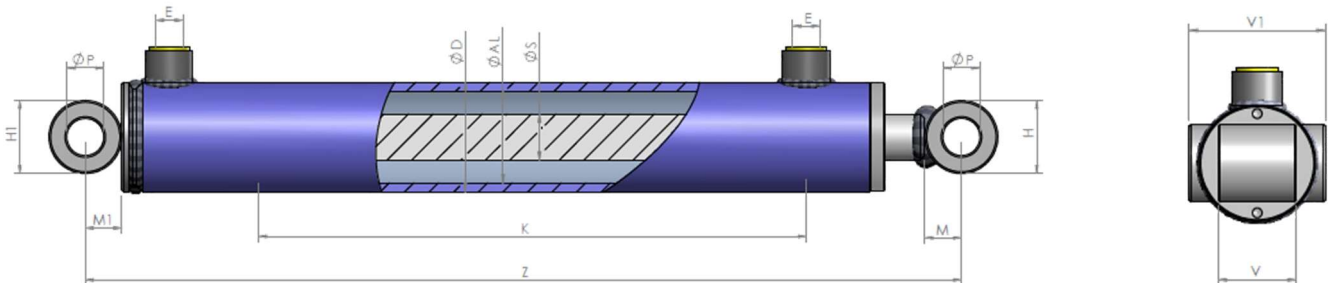

Codice Code	K	Z	Kg	E BSP	ØP	H	V	M	H1	V1	M1	Codice Code	K	Z	Kg
ØD 92 ØAL 80 ØS 40													ØD 92 ØAL 80 ØS 50		
X03-8040200	200	440	14,06	1/2"	30,25	60	60	30	60	110	30	X03-8050200	200	440	15,32
X03-80402500	250	490	15,19									X03-8050250	250	490	16,76
X03-80403000	300	540	16,31									X03-80503000	300	540	18,12
X03-80404000	400	640	18,56									X03-80504000	400	640	20,93
X03-80405000	500	740	20,81									X03-80505000	500	740	23,74
X03-80406000	600	840	23,06									X03-80506000	600	840	26,54
X03-80407000	700	940	25,32									X03-80507000	700	940	29,35
X03-80408000	800	1040	27,65									X03-80508000	800	1040	32,15
X03-80401000	1000	1240	32,06									X03-80501000	1000	1240	37,76
ØD 105 ØAL 90 ØS 50															
X03-90503000	300	556	23,50	1/2"	40,25	70	70	35	70	130	35				
X03-90504000	400	656	26,83												
X03-90505000	500	756	30,16												
X03-90506000	600	856	33,50												
X03-90507000	700	956	36,98												
X03-90508000	800	1056	40,17												
X03-90501000	1000	1256	46,83												
ØD 115 ØAL 100 ØS 50													ØD 115 ØAL 100 ØS 60		
X03-10050200	200	480	23,69	1/2"	40,25	70	70	35	70	130	35	X03-10060300	300	580	29,49
X03-10050250	250	530	25,72									X03-10060400	400	680	33,61
X03-10050300	300	580	27,35									X03-10060500	500	780	38,04
X03-10050400	400	680	30,99									X03-10060600	600	880	42,00
X03-10050500	500	780	34,38									X03-10060700	700	980	46,44
X03-10050600	600	880	38,03									X03-10060800	800	1080	50,63
X03-10050700	700	980	41,54									X03-100601000	1000	1280	58,78
X03-10050800	800	1080	44,80												
X03-100501000	1000	1280	52,09												

CARATTERISTICHE TECNICHE TECHNICAL SPECIFICATIONS

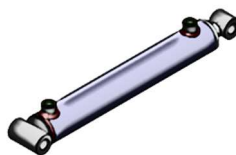

Serie X03

ALESAGGIO - BORE [mm]		25	32	40	50	60	63	70	80	90	100	120
FORZA IN SPINTA - OUTPUT FORCE [Kg]	p bar 100	501	820	1.281	2.002	2.883	3.179	3.924	5.126	6.487	8.009	11.533
	p bar 160	801	1.312	2.050	3.203	4.613	5.086	6.279	8.201	10.379	12.814	18.452
	p bar 250	1.251	2.050	3.203	5.005	7.208	7.947	9.811	12.814	16.218	20.022	28.831

ALESAGGIO - BORE [mm]		25	32	40		50		60		63	70		80	90	100		120	
STELO - ROD [mm]		16	20	20	25	25	30	30	35	40	40	35	40	40	50	50	60	70
FORZA IN TIRO - INPUT FORCE [Kg]	p bar 100	296	500	961	781	1.502	1.281	2.162	1.902	1.602	1.897	2.943	2.643	3.844	4.485	6.007	5.126	7.608
	p bar 160	473	800	1.538	1.249	2.403	2.050	3.460	3.043	2.563	3.036	4.709	4.229	6.151	7.176	9.610	8.201	12.173
	p bar 250	739	1.249	2.403	1.952	3.754	3.203	5.406	4.755	4.004	4.743	7.358	6.607	9.610	11.212	15.016	12.814	19.021

Pressione Massima - Max. Pressure: 250 Bar

Il dato della pressione è sempre da verificare in base all'applicazione del cilindro.

The pressure value is always to be checked depending on the application of the cylinders.

PRODOTTO - PRODUCT	MATERIALE - MATERIAL
TUBO LUCIDO POLISHED TUBE	ACCIAIO: St 52.3 DIN 2393 ISO H9 STEEL: St 52.3 DIN 2393 ISO H9 - S355 H8
STELO CROMATO CHROMED ROD	ACCIAIO: UNI C45 - cromo 25µm Rating 9/200h STEEL: UNI C45 - chrome 25µm Rating 9/200h - 20MNV6
TESTATA DI GUIDA HEAD BUSH	GHISA: EN-GJL 250 (G25-UNI 5007 / EN 1561) HYDRAULIC CAST IRON: EN-GJL 250 (G25-UNI5007 / EN1561)
PISTONE PISTON	ACCIAIO: 9SMn28 STEEL: 9SMn28
FONDELLO END PLUG	ACCIAIO: S355J0 (Fe510C) - S355JR (A105) STEEL: S355J0 (Fe510C) - S355JR (A105)
BORCHIA FILETTATA THREADED PORT	ACCIAIO STEEL
BOCCOLA BUSH	ACCIAIO: S355J0 (FE510C) STEEL: S355J0 (FE510C)
SET GUARNIZIONI HEAD BUSH – HEAD BUSH SEAL KITS	
GUARNIZIONE: O-RING SEAL: O-RING	NBR 70 SHORE NBR 70 SHORE
GUARNIZIONE: GHK SEAL : GHK	POLIURETANO POLYURETHANE
GUARNIZIONE: TSE-TTS-TTI/L SEAL: TSE-TTS-TTI/L	TSE: NBR+TESSUTO TTS-TTI/L: POLIURETANO TSE: NBR+FABRIC TTS-TTI/L: POLYURETHANE
GUARNIZIONE: O-RNG SEAL: O-RING	NBR 70 SHORE NBR 70 SHORE
SET GUARNIZIONI PISTON – PISTON SEAL KITS	
GUARNIZIONE: TPM SEAL: TPM - PDP - PDH	NBR+POM+TPE NBR+POM+TPE - NBR+POM+ POLYURETHANE - NBR+PTFE+POM
GUARNIZIONE: O-RNG SEAL: O-RING	NBR 70 SHORE NBR 70 SHORE
Velocità Limite - Top Speed: max 0,5 m/s - Temperatura C° - Temperature C°: -25°C - +80°C	